

Render and finish over Insulation (refer to project specific specification)

UPVC Movement bead fixed to base coat with fir tree fixings. Ensure mesh is broken at movement joint location. Movement bead to suit system, refer to project specific specification

NOTE: Movement joints should be installed at 6-8m centres

SYSTEM ONLY MOVEMENT BEAD

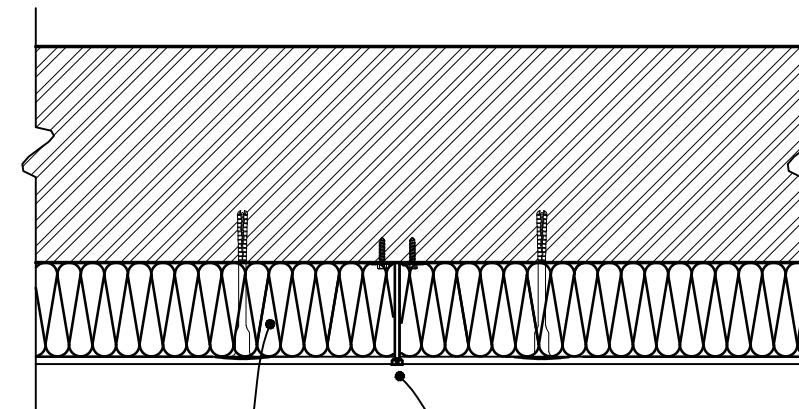

Render and finish over Insulation (refer to project specific specification)

PPC Aluminium Full system movement bead fixed to substrate with FX-N-06K040 fixings at 300mm c/c's. Movement bead to suit system, refer to project specific specification

NOTE: Movement joints should be installed at 6-8m centres

Note a. - The full system movement joint should be shimmed as necessary at the fixing locations to achieve good alignment. If any large gaps exist at the back of the MJ these should be sealed with expanding foam before fitting the main insulation to the wall.

FULL SYSTEM MOVEMENT BEAD

Date:	Rev:	Notes	Date:	Rev:	Notes	Date:	10/06/2013	DETAIL REF:	Rev.	Genesis Centre North Staffs Business Park Innovation Way Stoke-on-Trent ST6 4BF Tel: 01782 366090 Fax: 01782 366091 Mobile: 07824 34 4643
						Drawn by:	JT	A.10	P1	
						Checked by:	IC	TITLE:		
						Scale :	1:5@A3	MOVEMENT JOINT DETAILS		